



**17/87 Mary Street UNLEY SA**

2 1 1

Fantastic investment opportunity in one of Adelaide's most highly sort after locations. Only 5 minutes to Adelaide's City Centre and less than 50 metres to King William Road with some of Adelaide's best cafes, restaurants and bars, a huge variety of boutique shopping to choose from and excellent schooling nearby. Zoned for Unley Primary School and Glenunga International High School.

**Price** : \$ 270,000

**View** : <https://www.bruse.com.au/sale/sa/eastern-suburbs/unley/residential/unit/5549532>

Positioned in a quiet group of units surrounded by appealing communal grounds, this renovated 2 bedroom unit is perfect for buyers looking for a low maintenance investment to add to their portfolio. Currently tenanted for \$285 per week until 30th March 2020.



**Toby Shipway**  
8413 8181

This solid brick unit consists of very comfortable living with two generous bedrooms both with built in robes and the renovated bathroom and combined laundry conveniently

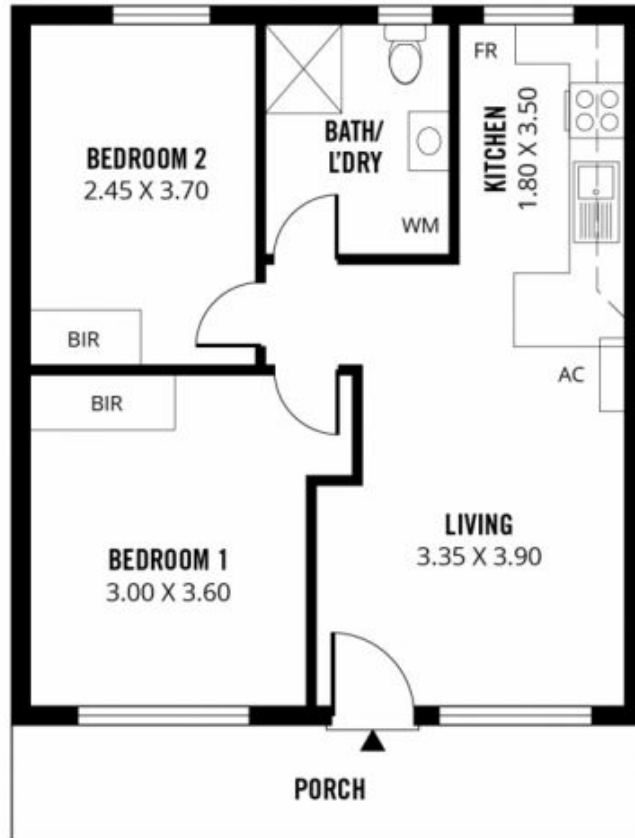
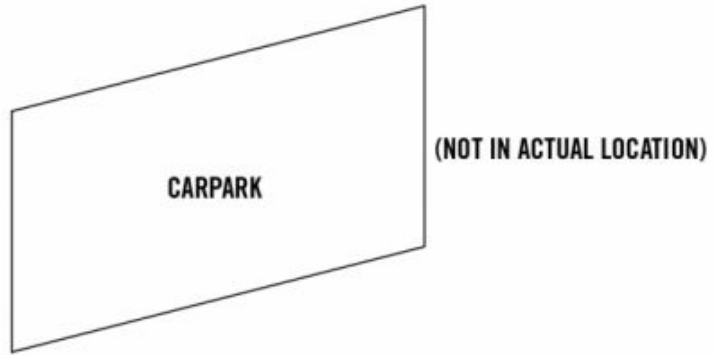

**TOTAL**



Living

Scale in metres. This drawing is for illustration purposes only. All measurements are approximate and details intended to be relied upon should be independently verified. Produced by **The Fotobase Group**