



83B Ashbrook Avenue PAYNEHAM SOUTH SA

4 🏠 2 🚗 2 🚗

SOLD BY BEVAN & THEON BRUSE. TO GET THE MAXIMUM PRICE WITH THE MINIMUM OF FUSS CALL BEVAN BRUSE OR THEON BRUSE TODAY!

Land Size : 462 sqm
View : <https://www.bruse.com.au/sale/sa/eastern-suburbs/payneham-south/residential/house/551030>

Modern, contemporary and beautifully built. An absolute masterpiece.

- Extremely large with 307m2 of home!
- Amazing main bedroom suite on the lower level.
- 4 bedrooms in total.
- Storage, storage & more storage!
- Fantastic outdoor living areas.

You truly need to view this home to appreciate the impeccable quality and the well thought out design. It is very impressive!

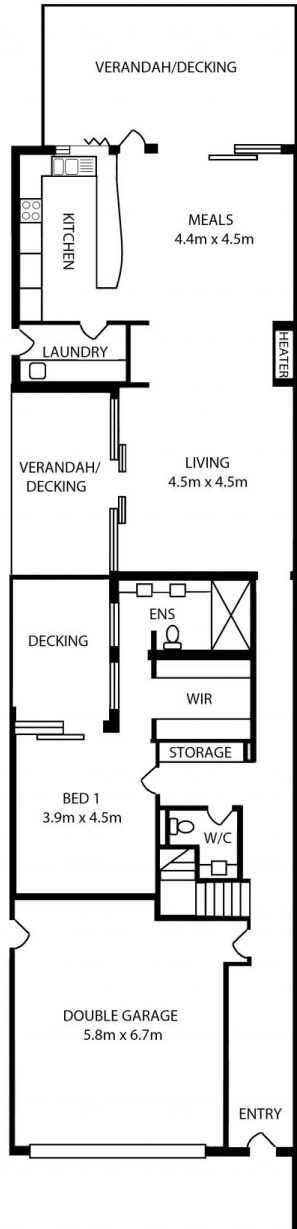

Area	m2
Ground Floor	152.16
Upper Floor	81.30
Garage	43.47
Verandah	30.15
Total	307.09

