



2A Alton Avenue MAGILL SA

3 2 2

****SOLD BY BEVAN & THEON BRUSE. TO GET THE MAXIMUM PRICE WITH THE MINIMUM OF FUSS CALL BEVAN BRUSE OR THEON BRUSE TODAY****

Land Size : 428 sqm
View : <https://www.bruse.com.au/sale/sa/eastern-suburbs/magill/residential/house/5551059>

A lovely home with spacious and light filled living areas. Single level. Pretty garden setting.

What a unique new age style home. Thanks to the extra wide frontage, this well designed home benefits from all rooms enjoying a great outlook and an abundance of natural light. You will love the low maintenance design.

Set on a 428m2 (approx) allotment with 2 generous living areas including a formal living area (that could be set up as a fourth bedroom) and an attractive family living and dining room. Adjacent the main living space is a delightful kitchen with a large breakfast bar and plenty of storage. Via the

APPROX ESTIMATED AREA

LIVING	136.4
VERANDAH	47.1
GARAGE	23.2
TOTAL	206.7m²

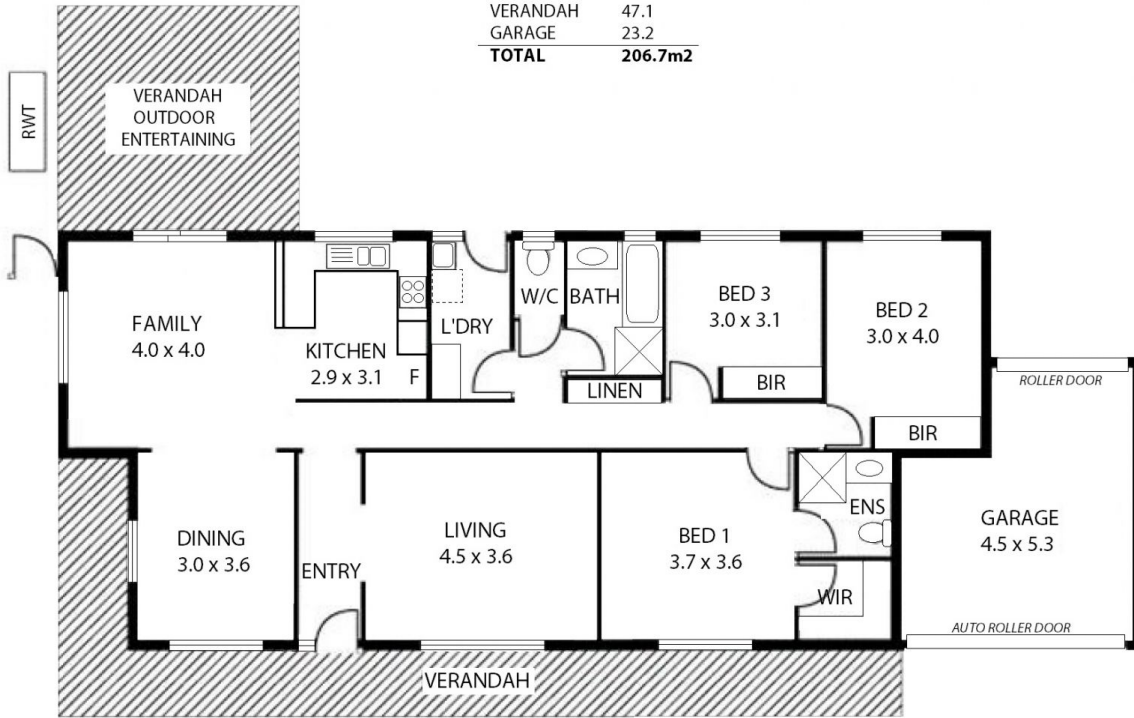

22.31m

19.20m

428m²
(Approx)

19.20m

22.31m

ALTON AVENUE