



Residence 4C Parkview Place ATHELSTONE SA

3 2 2

A wonderful opportunity featuring designer decor. A quality built home built on 2 levels in a group of 3 homes. Completely separate. Built in 2006.

Land Size : 295 sqm
View : <https://www.bruse.com.au/sale/sa/north-north-east-suburbs/athelstone/residential/house/5551159>

This home offers a very flexible floor plan for family living or couples seeking to acquire a designer lifestyle home.

The property adjoins a council reserve at the rear and has a lovely backdrop of trees and shrubs that make this completely different to the majority of new homes.

A lovely garden setting with a very desirable balcony and decking area gives this property a great feel.

The property includes a generous open plan living area with direct access to the balcony with stainless steel wiring, giving this a magnificent outlook to the reserve. Adjacent to

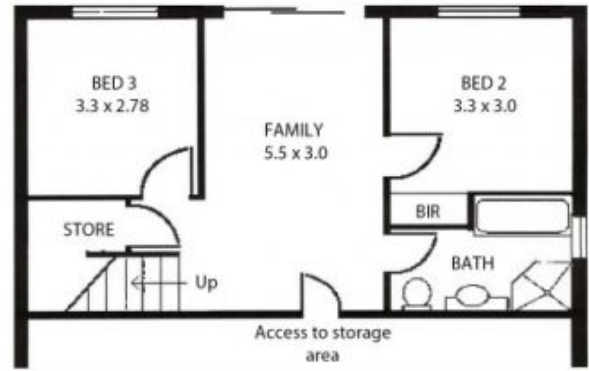

Lower Level



RESERVE

13.35

21.37

295m²

20.76

6.31

3.21

6.50

PARKVIEW PLACE