



**86 Tait Street RENOWN PARK SA**

4 2 3

An excellent opportunity to purchase a family home in this fantastic location. So close to the city.

Huge room sizes with extra high ceilings.  
Big block on 764m<sup>2</sup> of land (approx.)  
Recently upgraded throughout.  
Large extension.  
Large sheds for the enthusiast.

4 Bedrooms (could be 6 if required)  
2 Sparkling bathrooms  
3 Separate living areas  
Stylish new kitchen  
Secure triple length carport  
Lots of storage and cupboards  
Beautiful polished timber floors  
Solid construction

**Land Size** : 764 sqm  
**View** : <https://www.bruse.com.au/sale/sa/western-beachside-suburbs/renown-park/residential/house/5551248>

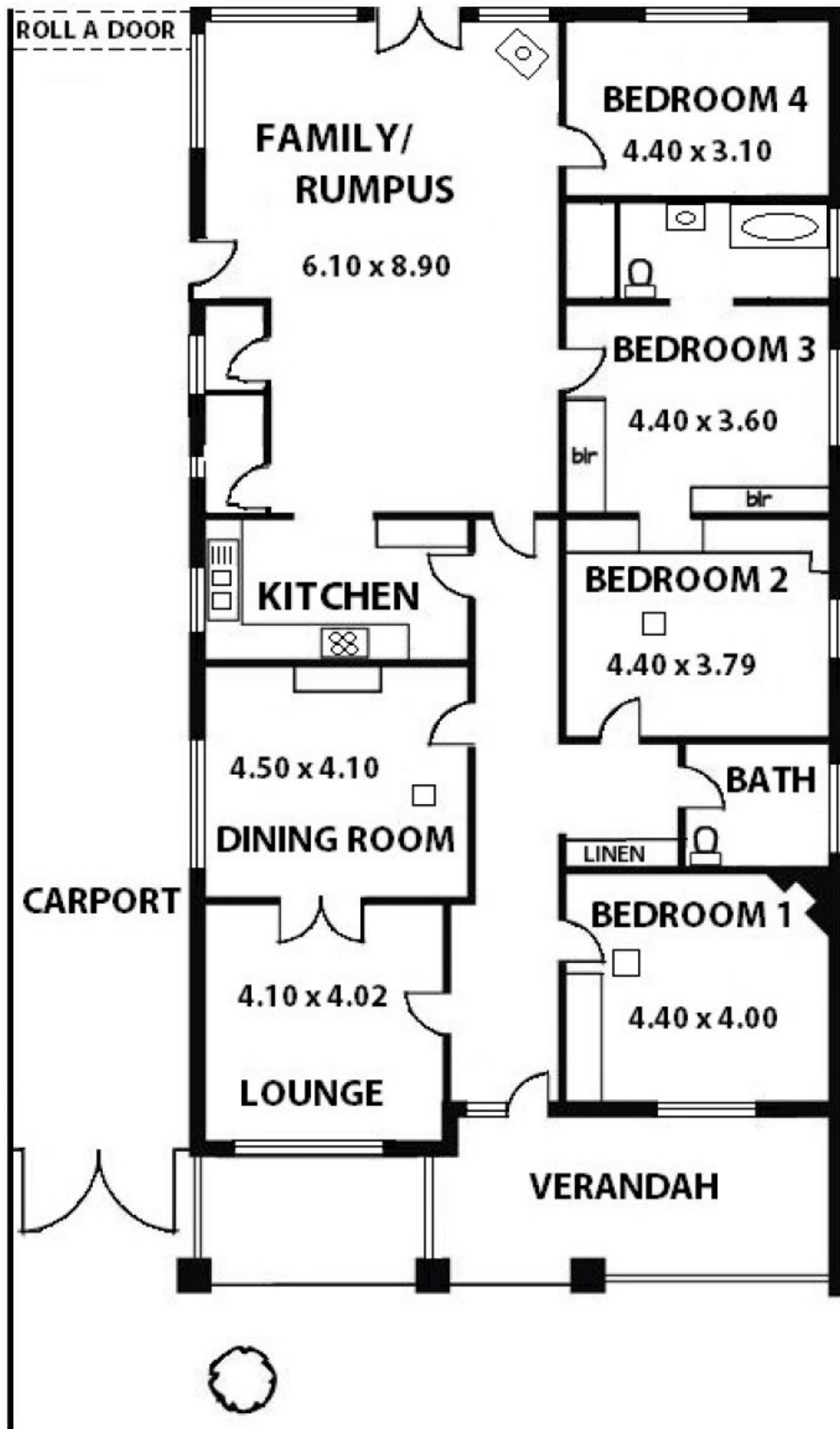

# TAIT STREET

15.84m

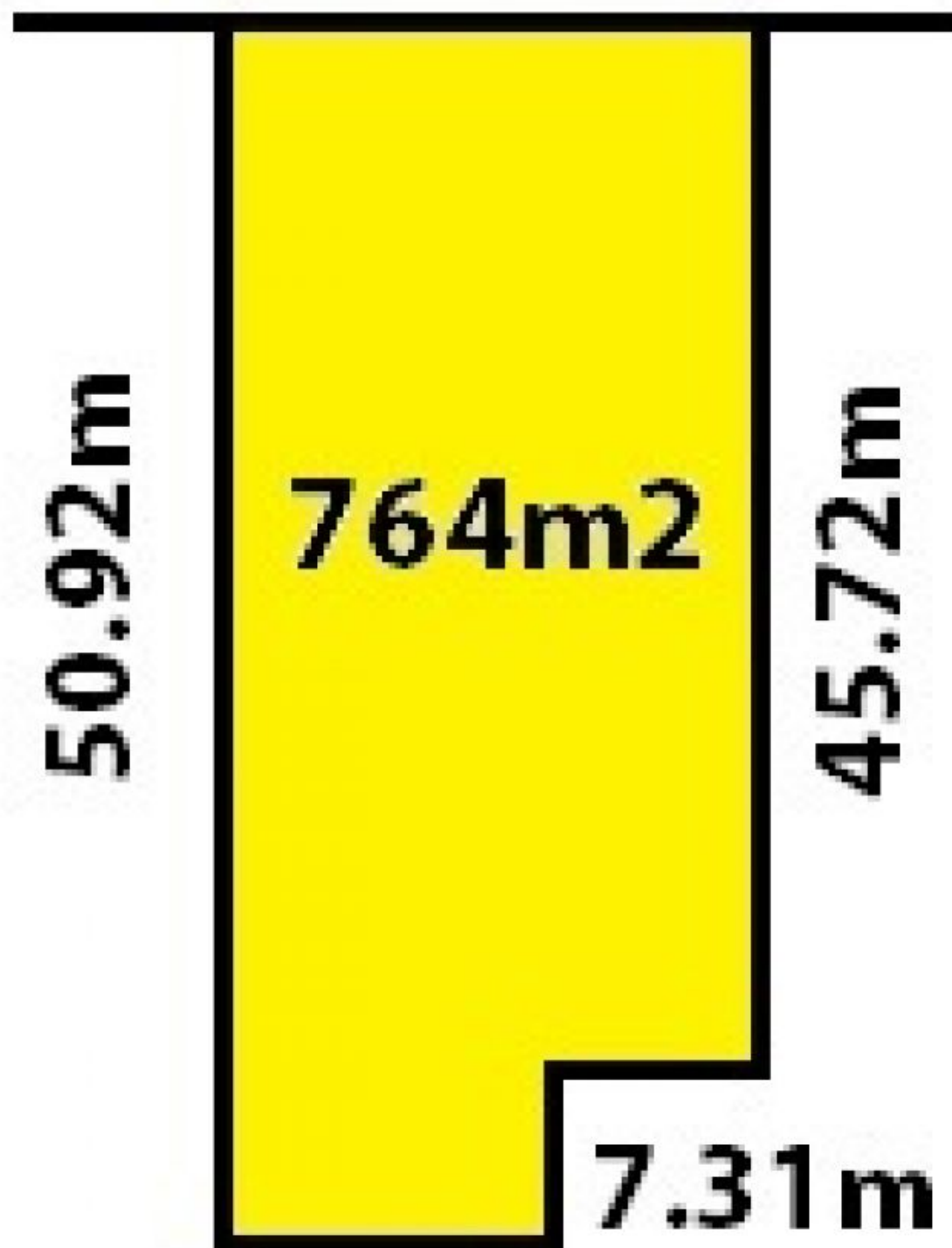

764m<sup>2</sup>

50.92m

45.72m

7.31m

8.53m