



**14 Palumbo Avenue NEWTON SA**

3  2  2 

**JUST COMPLETE!**

Spacious designs making the most of natural light to create harmony in your living environment. Generous room sizes throughout each home and good sized yards with undercover alfresco entertaining.

Home feature 3 bedrooms, 2 bathrooms and study areas.

Everything is included and to a very high standard.

The home has street frontage with separate driveways.

-Stylish kitchen complete with top quality Bosch appliances including a dishwasher. Ample storage and soft close drawers. Solid stone bench tops complete with designer feature sink and mixer.

**View** : <https://www.bruse.com.au/sale/sa/north-north-east-suburbs/newton/residential/house/5551323>



**Theon Bruse**  
**08 8431 8181**

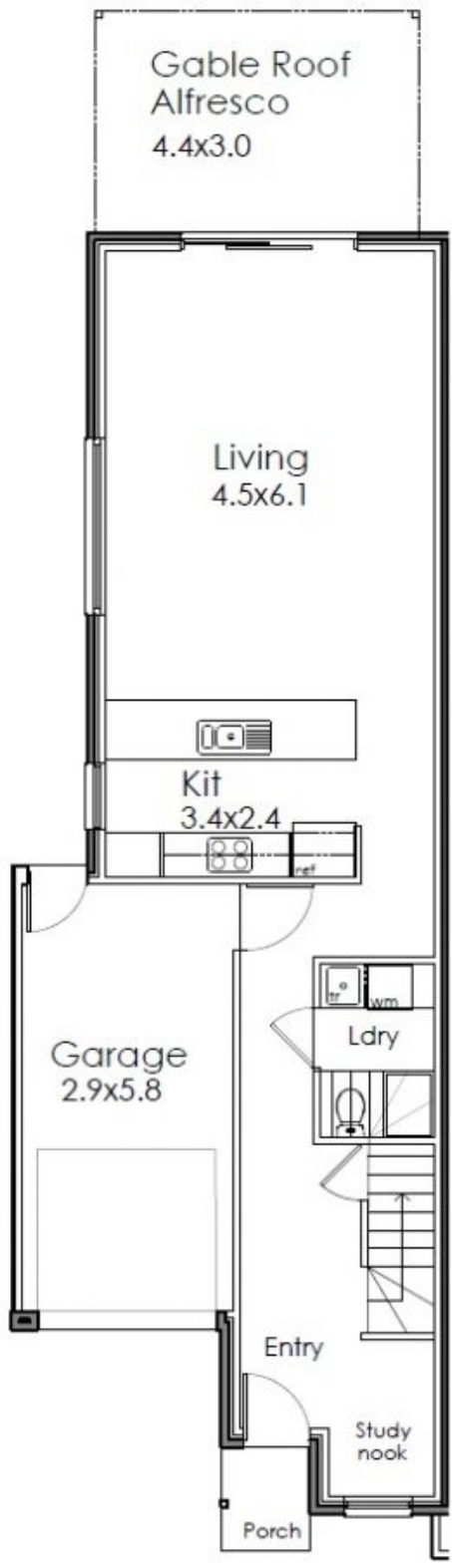

**Lower Floor Plan-  
Residence 1**

Residence 1	
Building Areas:	(m <sup>2</sup> )
Total Floor Area:	167.0
Lower Living :	66.8
Upper Living :	66.9
Garage:	19.2
Alfresco Pergola:	13.2
Porch:	1.9

**Upper Floor Plan-  
Residence 1**

