



22 Linden Avenue HAZELWOOD PARK SA

3 2 2

CORNER OF KIRKDALE AVENUE OVERLOOKING
LINDEN AVENUE GARDENS STREET SCAPE

Land Size : 368 sqm
View : <https://www.bruse.com.au/sale/sa/eastern-suburbs/hazelwood-park/residential/house/5551342>

*** There is no scheduled open inspection times for this property as it is Under Contract. Please disregard open inspections time listed in the Saturday Advertiser. It was too late to remove the advertised open inspection times. Apologies for the inconvenience. ***

The home features an entrance hallway that leads to a generous formal living room, with further access through to the 'hub of the home' kitchen, dining and everyday living area. These three areas open out through French doors to a delightful undercover vergola that is ideal for outdoor living and is surrounded by an attractive garden setting.



Bevan Bruse
08 8431 8181

The home further includes three good size bedrooms the

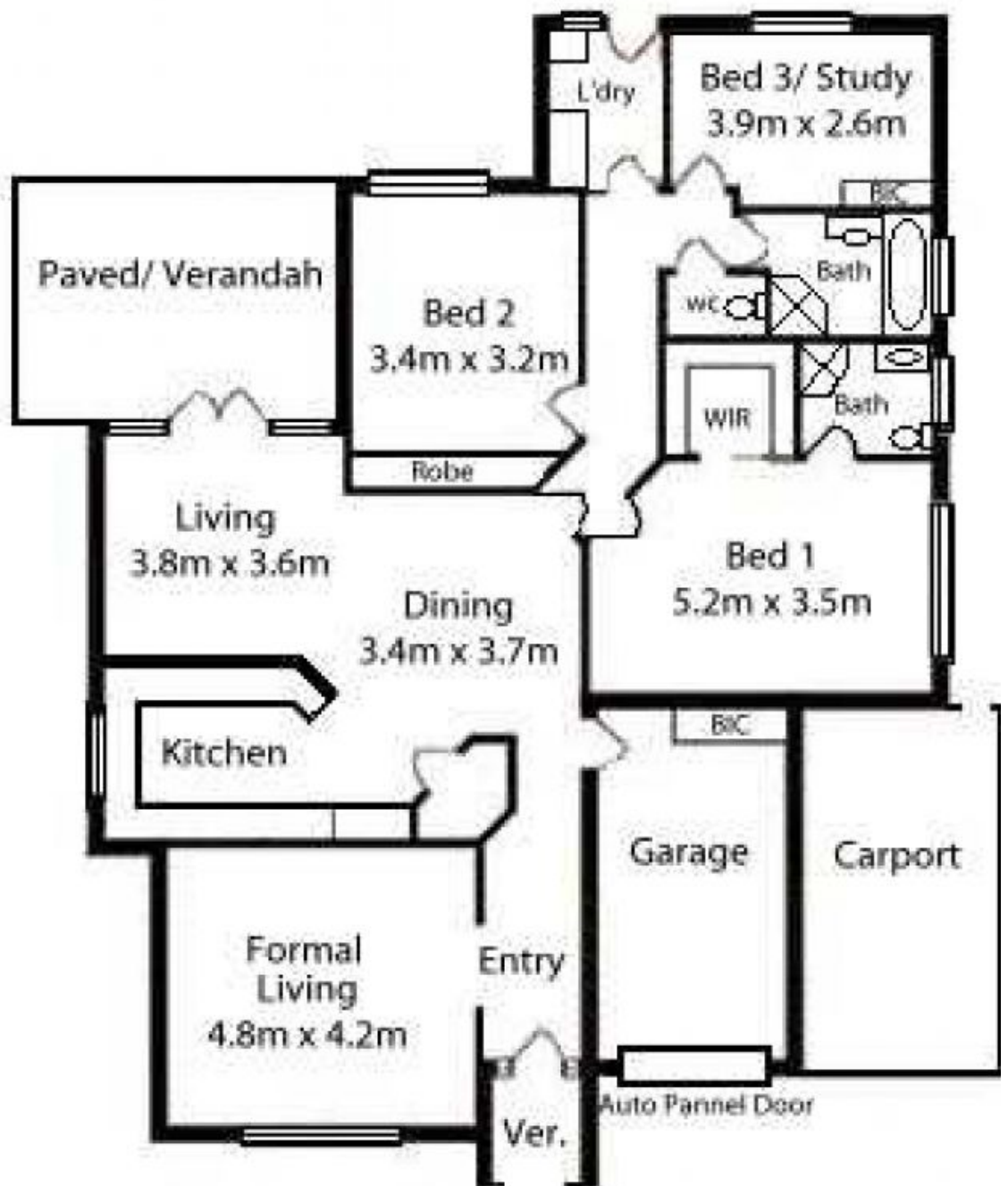



LINDEN AVENUE