



20 York Street VALLEY VIEW SA

3 2 2

A superb home with bright, open and airy feel. You will love the outlook.

Large 706m2 elevated allotment. Founders Reserve across the road.

- 2 spacious living areas
- Lower level rumpus room
- 3 bedrooms
- 2 bathrooms
- Double lockup garage
- Fully equipped kitchen
- Raised outdoor undercover deck area
- Lovely landscaped gardens

Type : House
Land Size : 706 sqm
View : <https://www.bruse.com.au/sale/sa/north-north-east-suburbs/valley-view/residential/house/5551348>



Theon Bruse
08 8431 8181

[For full version visit the website](#)

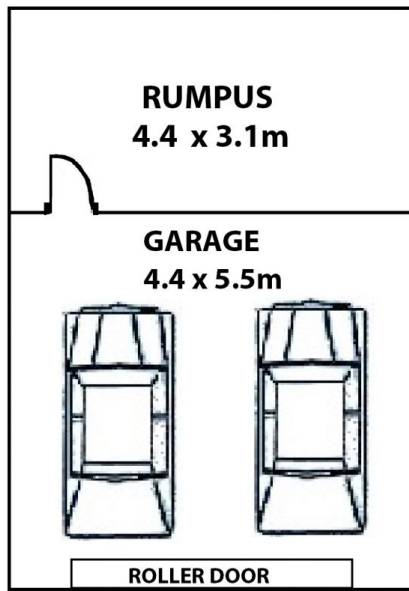

LOWER LEVEL

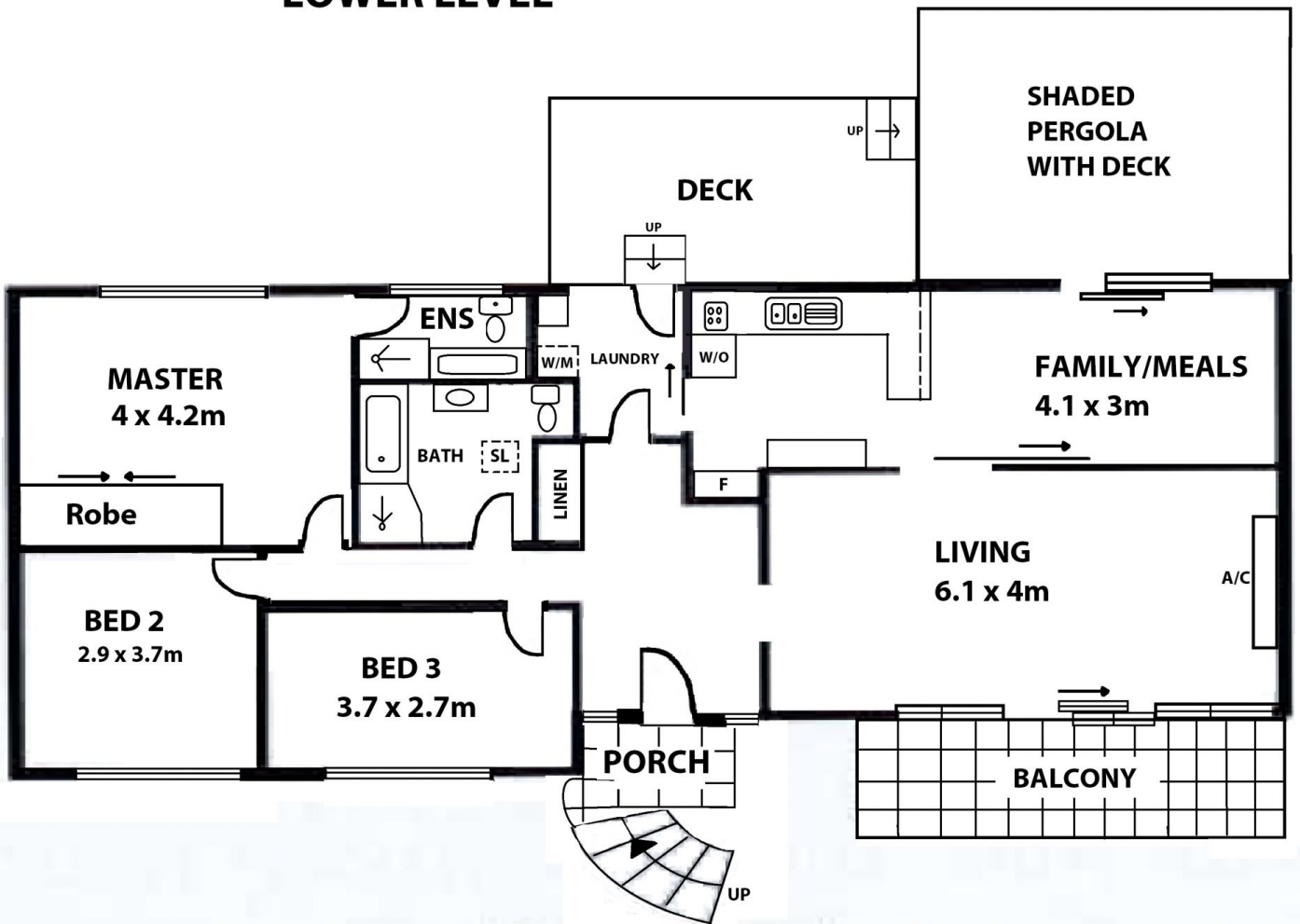
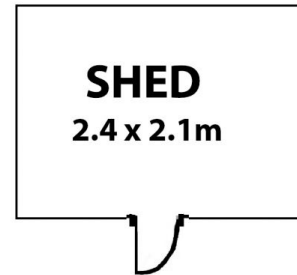

UPPER LEVEL

18.29

38.16

706m²

(approx.)

38.16

18.29

YORK STREET