

8 Tandanya Avenue HECTORVILLE SA

2 1 1

Only 1 street from Magill. This is a fab location to live or invest.

View : <https://www.bruse.com.au/sale/sa/eastern-suburbs/hectorville/residential/house/5551400>

Built to a very high standard by developer Onassis Developments. They prize themselves on building everlasting living environments to suit the lifestyles of 2018 & onwards.

- 2 huge bedrooms.
- Stunning double access designer bathroom.
- Stone bench tops to kitchen.
- Secure lock up garage.
- Stylish neutral colour tones to the interiors.
- Quality throughout
- Euro appliances including oven, gas cooktop, range hood and dishwasher.
- 2 Pak painted joinery



Theon Bruse
08 8431 8181

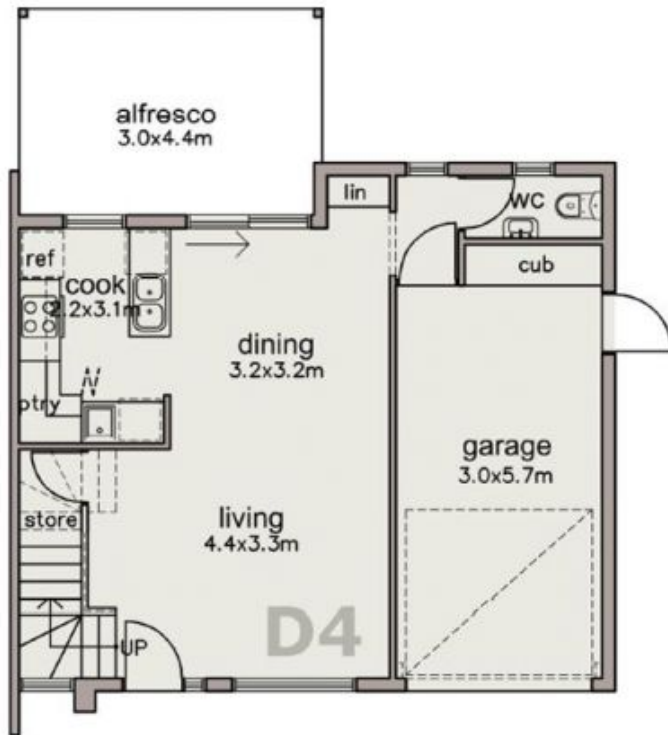

GROUND FLOOR PLAN

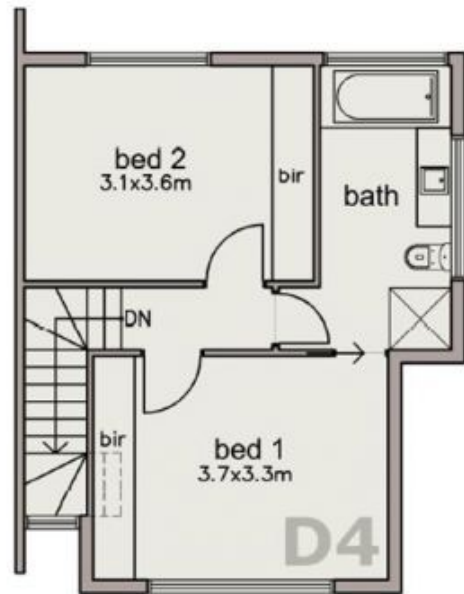

UPPER FLOOR PLAN

DWELLING 4

AREAS (sqm)



GROUND MAIN LIVING	UPPER MAIN LIVING	GARAGE	ALFRESCO	PORTICO	TOTAL
44.00	47.00	20.00	13.00	1.00	125.00

NOTE: THIS PLAN / DOCUMENT IS FOR ILLUSTRATION PURPOSES ONLY. ALL DIMENSIONS ARE APPROXIMATE. WHILE EVERY ENDEAVOUR HAS BEEN MADE TO VERIFY THE CORRECT DETAILS NEITHER THE VENDOR, THE AGENT, NOR THE DESIGNER ACCEPT LIABILITY FOR ERROR OR OMISSION



TANDANYA AVE



SITE PLAN

NOTE: THIS PLAN / DOCUMENT IS FOR ILLUSTRATION PURPOSES ONLY. ALL DIMENSIONS ARE APPROXIMATE. WHILE EVERY ENDEAVOUR HAS BEEN MADE TO VERIFY THE CORRECT DETAILS NEITHER THE VENDOR, THE AGENT, NOR THE DESIGNER ACCEPT LIABILITY FOR ERROR OR OMISSION