

3/1A Miller Street GLENELG EAST SA

3 2 2

These new residences have the "the look"!
Extremely spacious with up to 211m2 of house size.

ARCHITECTURALLY DESIGNED FOR A STYLISH
MODERN LOOK.
LUXURIOUS INTERIORS DESIGNED BY A
PROFESSIONAL INTERIOR DESIGNER.

Another "WP Property" development that sets a benchmark
standard of absolute sophistication and high end finishes.

The location is fantastic. Perfectly located just a short
1.8km walk to the beach and vibrant Jetty Road with an
array of cafes, restaurants, shopping and a cinema.
Bayside village shopping centre with Woolworths, local
gym, butcher and other specialty shops are also within
walking distance.

Price : \$ 699,000

View : <https://www.bruse.com.au/sale/sa/western-beach-side-suburbs/glenelg-east/residential/house/5551504>



Theon Bruse
08 8431 8181

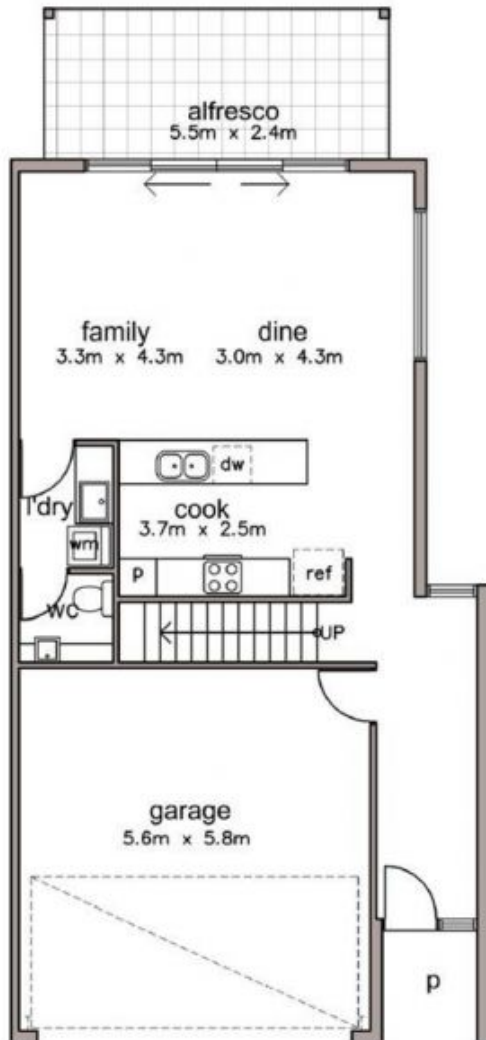

GROUND FLOOR PLAN

DWELLING 6



UPPER FLOOR PLAN

DWELLING 6

AREAS (sqm)

GROUND MAIN LIVING	UPPER MAIN LIVING	GARAGE	PORTICO	ALFRESCO	TOTAL
62.90	74.00	34.60	03.10	13.20	187.80



NOTE: THIS PLAN / DOCUMENT IS FOR ILLUSTRATION PURPOSES ONLY. ALL DIMENSIONS ARE APPROXIMATE. WHILE EVERY ENDEAVOUR HAS BEEN MADE TO VERIFY THE CORRECT DETAILS NEITHER THE VENDOR, THE AGENT, NOR THE DESIGNER ACCEPT LIABILITY FOR ERROR OR OMISSION

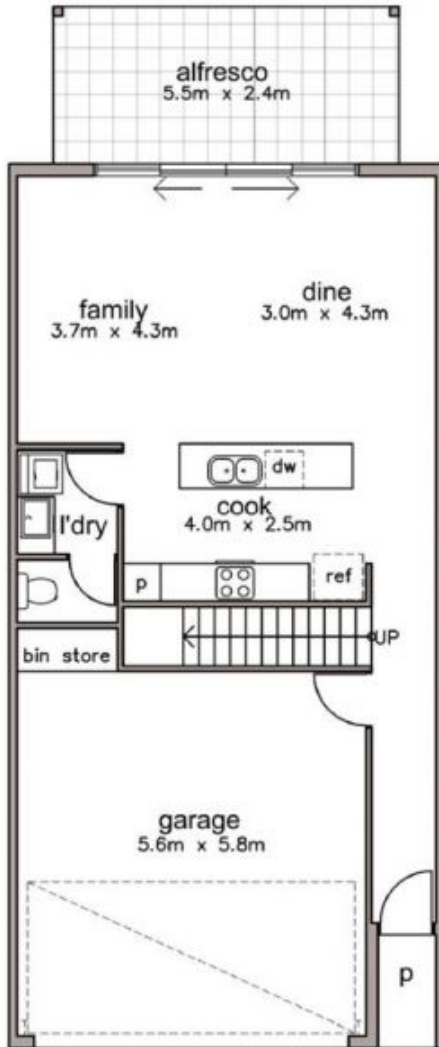

GROUND FLOOR PLAN
DWELLING 8

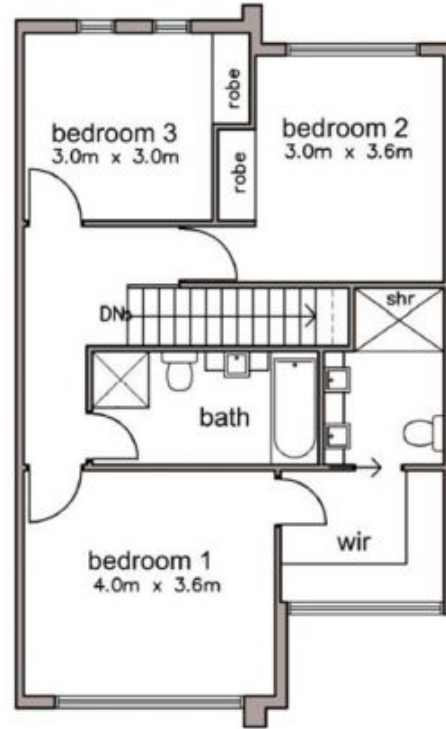

UPPER FLOOR PLAN
DWELLING 8

AREAS (sqm)

GROUND MAIN LIVING	UPPER MAIN LIVING	GARAGE	PORTICO	ALFRESCO	TOTAL
60.10	70.90	35.60	01.90	13.20	181.70



NOTE: THIS PLAN / DOCUMENT IS FOR ILLUSTRATION PURPOSES ONLY. ALL DIMENSIONS ARE APPROXIMATE. WHILE EVERY ENDEAVOUR HAS BEEN MADE TO VERIFY THE CORRECT DETAILS NEITHER THE VENDOR, THE AGENT, NOR THE DESIGNER ACCEPT LIABILITY FOR ERROR OR OMISSION