

**34 John Street PAYNEHAM SA**

2 1 1

Low maintenance living with a trendy style. Perfect property for the busy lifestyle. Excellent investment opportunity.

**View** : <https://www.bruse.com.au/sale/sa/eastern-suburbs/payneham/residential/house/5551508>

The location is excellent. Only a short commute to the city. Close to Norwood Parade. The groups private driveway is directly opposite Payneham oval & playground. There is plenty of open green space for wind down walks at your door step. Payneham is a hot spot for property with potential for excellent growth.

The moment you enter the home you get a wonderful feeling of open space. Natural light floods through the stylish floor to ceiling windows and high lofty ceilings create a great ambience. The solid brick construction will appeal to buyers and the lovely private back yard is perfect for outdoor entertaining with family and friends.



**Theon Bruse**  
08 8431 8181



LOWER LEVEL

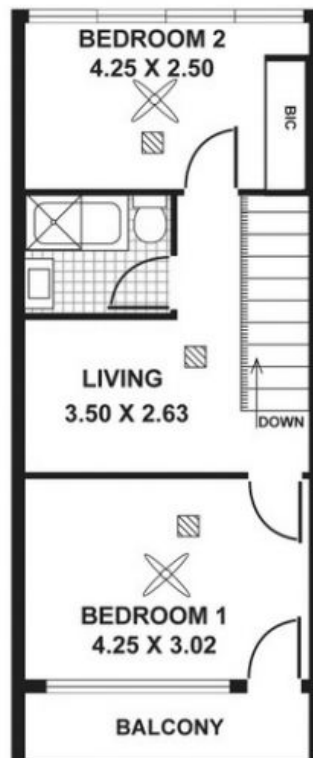

UPPER LEVEL

