



1 Schulze Court ATHELSTONE SA

3 1 2

Enjoy the wonderful lifestyle of Athelstone.

This beautifully maintained home sits on a wide corner allotment of 630m² and has been cleverly designed to have an attractive outlook from all windows in the home. Natural light saturates all rooms thanks to the large picture windows. It really is refreshing the moment you walk inside.

To the front of the home is the large formal living and formal dining rooms. The central kitchen which has been recently renovated separates the casual living and everyday meal areas.

The bonus room is the fantastic sunroom. This space is light & bright and could be used as a great indoor children's play room, studio or just a room to enjoy on a sunny day.

Land Size : 630 sqm
View : <https://www.bruse.com.au/sale/sa/north-north-east-suburbs/athelstone/residential/house/5551662>



Theon Bruse
08 8431 8181

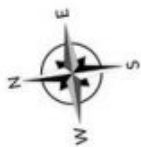
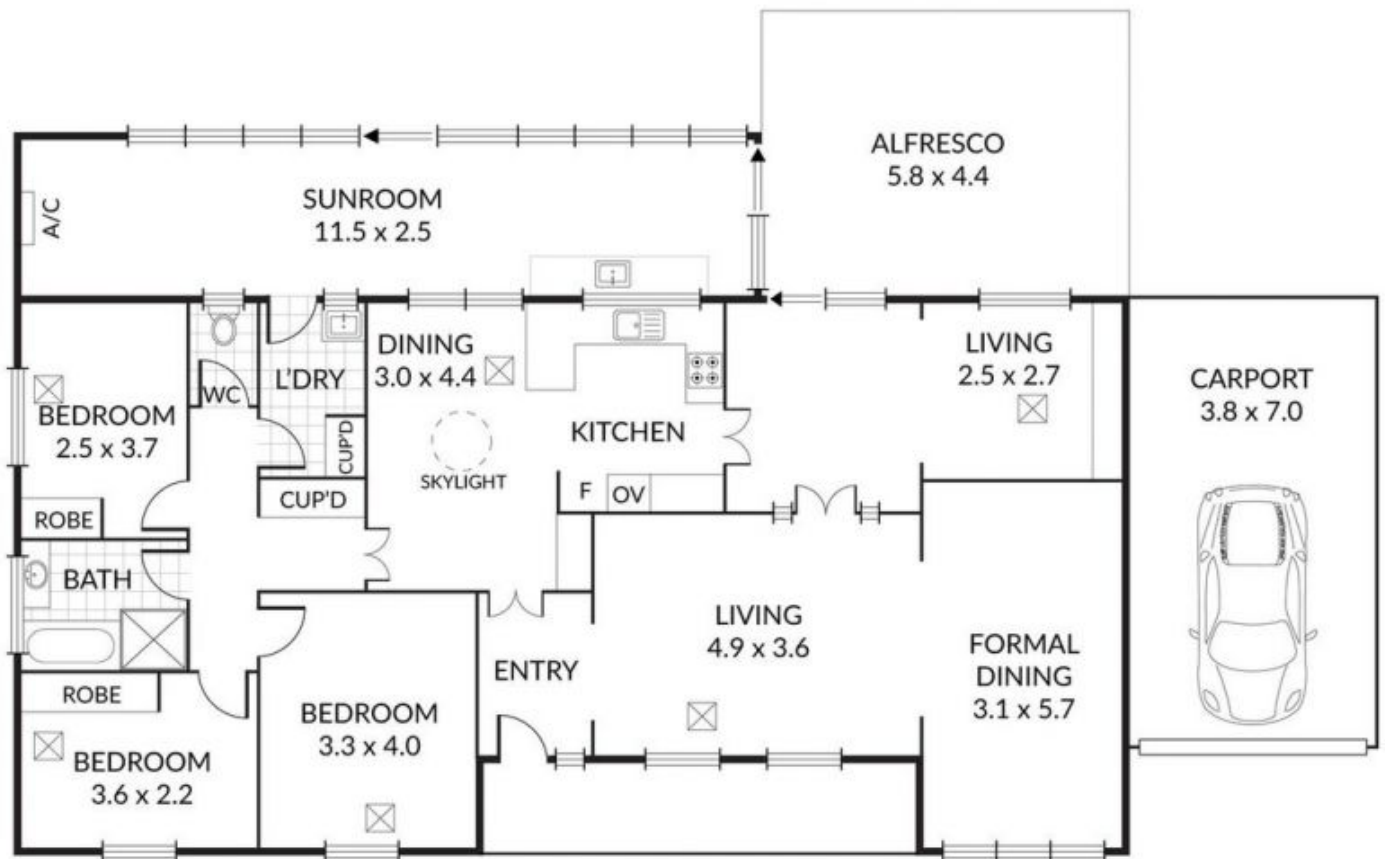

INTERNAL AREAS	165 M2
EXTERNAL AREAS	53 M2
TOTAL	218 M2

Scale in metres. Indicative only. Dimensions are approximate. All information contained herein is gathered from sources we believe to be reliable. However we cannot guarantee its accuracy and interested persons should rely on their own enquiries