

**9 Inverell Avenue NORTH PLYMPTON SA**

3  1  1 

THIS PROPERTY OFFERS THE OPPORTUNITY TO PURCHASE IN THIS AMAZING LOCATION. A HOME WHERE YOU CAN JUST MOVE IN, LIVE AND ENJOY A WONDERFUL LIFE WITH 3 GOOD SIZED BEDROOMS, A FOURTH ROOM AS A STUDY OR AS A SECOND LIVING AREA AND ALSO WITH A GENEROUS LIVING AREA, GENEROUS KITCHEN, GENEROUS DINING ROOM AND ALSO AN EXCELLENT UPGRADED BATHROOM.

This home is an ideal opportunity for any buyer seeking to get into this marvellous location, so close to the city, so close to the beach and close to every other convenience that Plympton offers.

It is a very popular location, don't miss this one this weekend; It's a good one.

**Land Size** : 389 sqm  
**View** : <https://www.bruse.com.au/sale/sa/south-south-east-suburbs/north-plympton/residential/house/5551696>



**Bevan Bruse**  
**08 8431 8181**

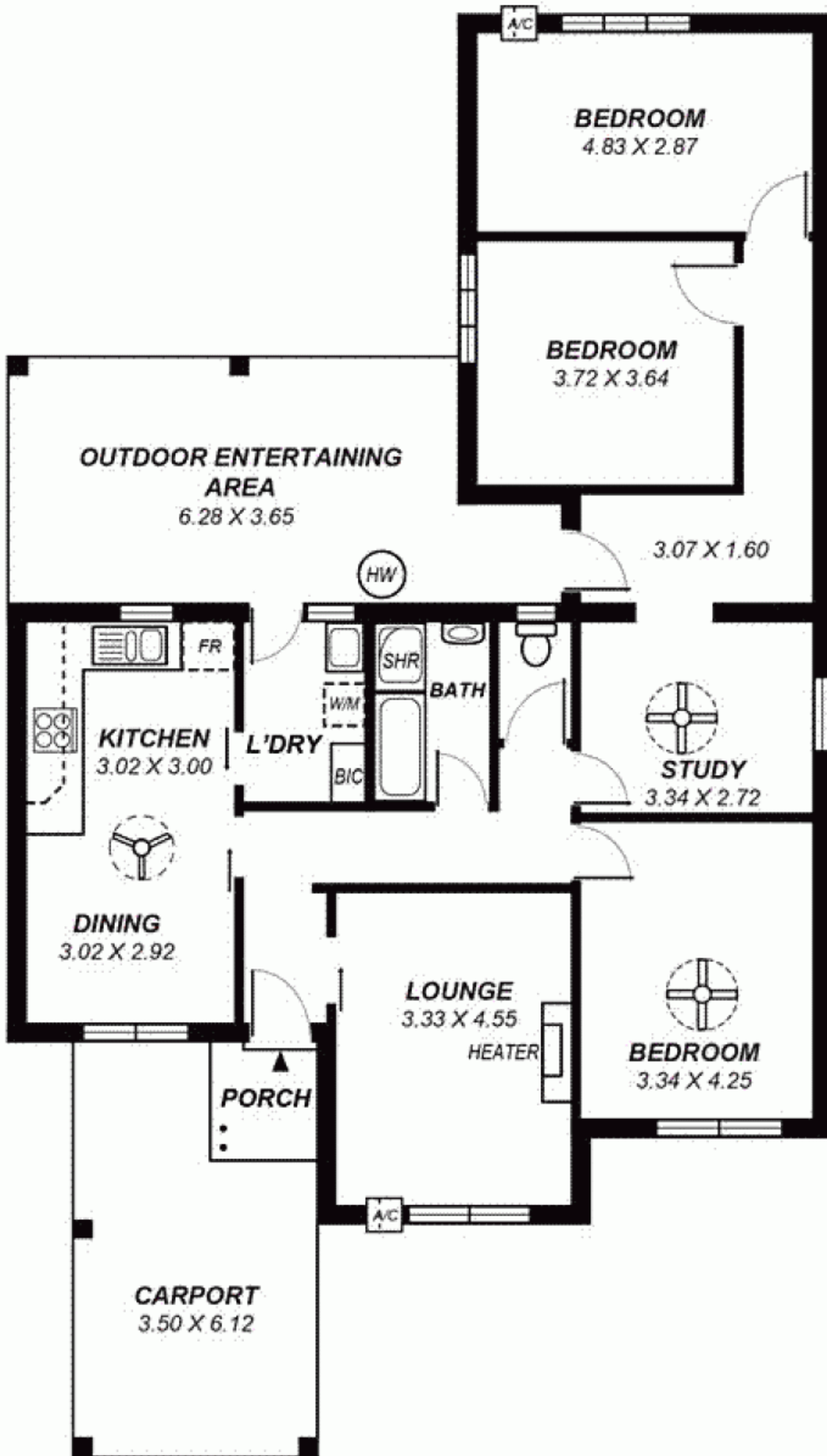

*This drawing is for illustration purposes only .  
 All measurements are approximate and details intended  
 to be relied upon should be independently verified.*



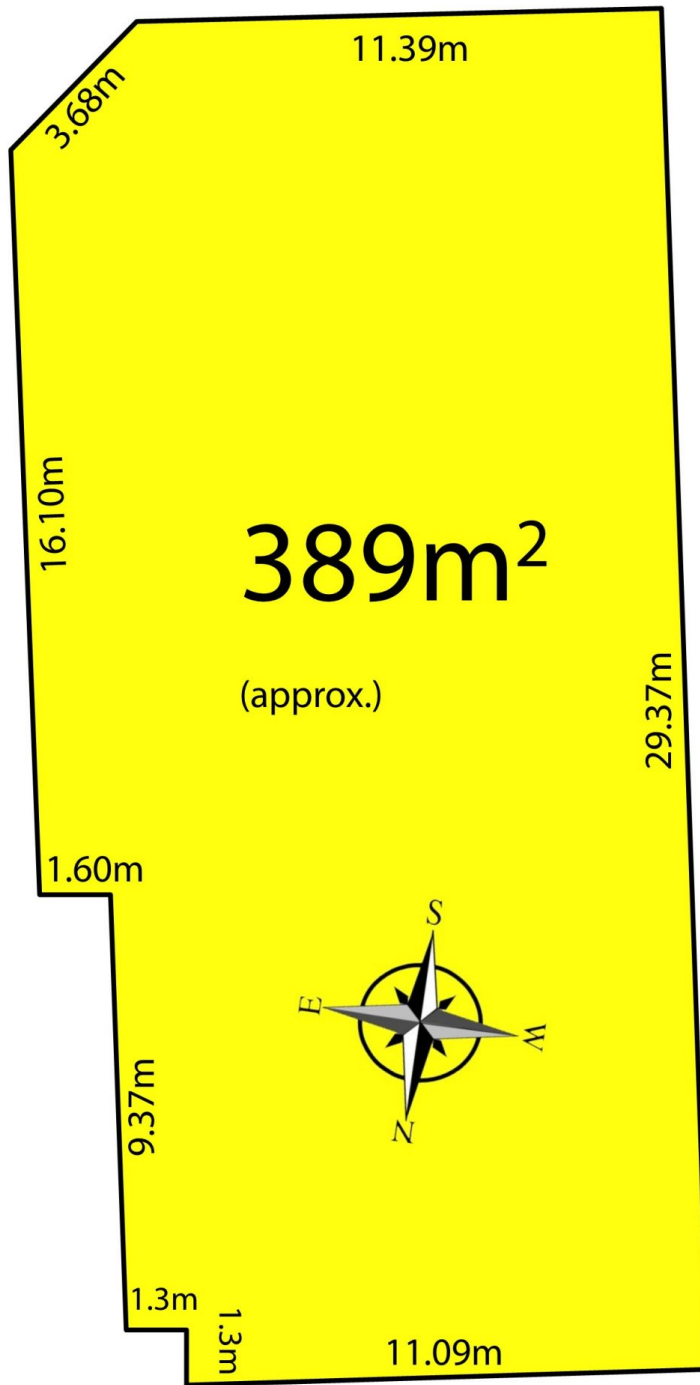

INVERELL AVENUE