

2/30 Walkerville Terrace GILBERTON SA

2 1 1

Great value for money in highly regarded Gilberton.

This spacious homette offers buyers the opportunity to move in as it is or add value by doing some small cosmetic upgrades.

Price : \$ 422,000

View : <https://www.bruse.com.au/sale/sa/north-north-east-suburbs/gilberton/residential/house/5551716>

The floor plan is fantastic

- Very large living and lounge room.
- Separate dining room.
- Separate kitchen.
- Lovely French doors.
- Huge main bedroom 4.7m x 4.1m.
- Feature bay windows.
- Large lock up garage with extra room for storage.
- Private rear yard.
- Built to a very high standard.



Theon Bruse
08 8431 8181

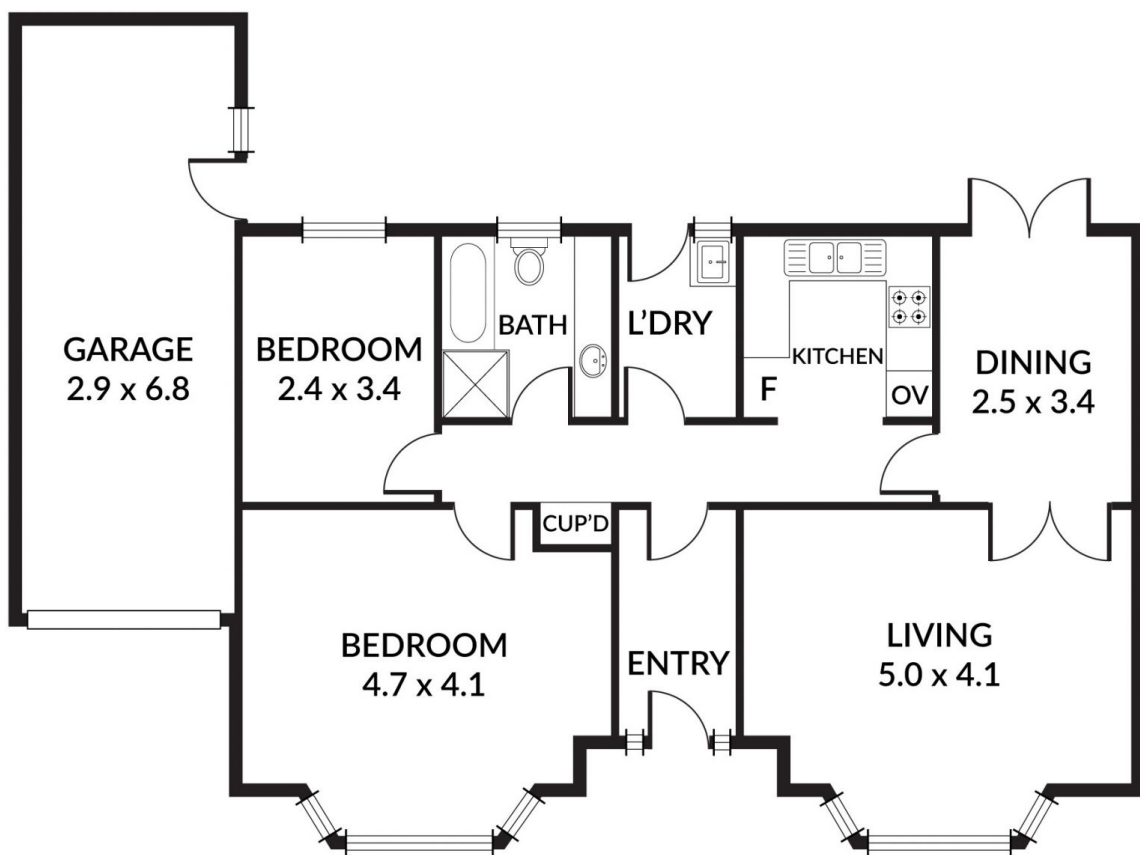

0 1 2 3 4 5

Scale in metres. Indicative only. Dimensions are approximate. All information contained herein is gathered from sources we believe to be reliable. However we cannot guarantee its accuracy and interested persons should rely on their own enquiries