



**24A Birdwood Terrace NORTH PLYMPTON SA**

3 2 2

JUST 2 YEARS OLD AND IMPECCABLY MAINTAINED. THIS LUXURIOUS DESIGNER STYLE HOME WILL SUIT THE DISCERNING BUYERS, IT REALLY IS SOMETHING OUT OF THE BOX.

**View** : <https://www.bruse.com.au/sale/sa/south-south-east-suburbs/north-plympton/residential/house/5551720>

This home is for the perfectionist. Absolutely amazing. Don't miss it, it is a great opportunity to acquire a stunning home in a marvellous location, close to everything. Halfway to the city and halfway to the beach. There is a bicycle track right out the front that allows you to ride to both the city and the beach. What a way to live.



**Bevan Bruse**  
**08 8431 8181**

The home comprises of an entrance area which gives you a feeling of space the moment you walk in the door. The residence includes a wonderful open plan living, dining and kitchen with every conceivable appliance in the kitchen and ample cupboard and bench space. The dining area of the

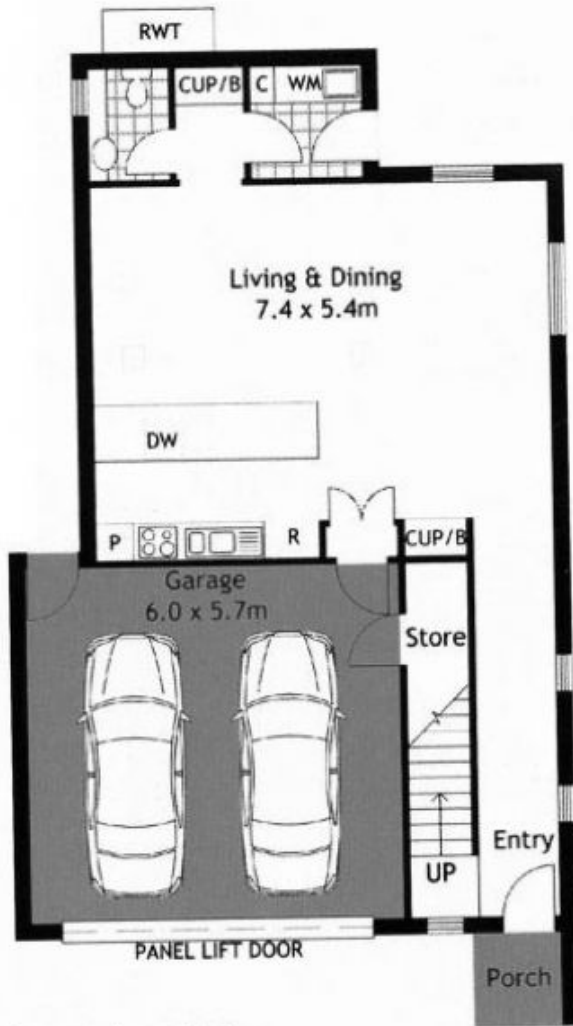

Lower Level Plan

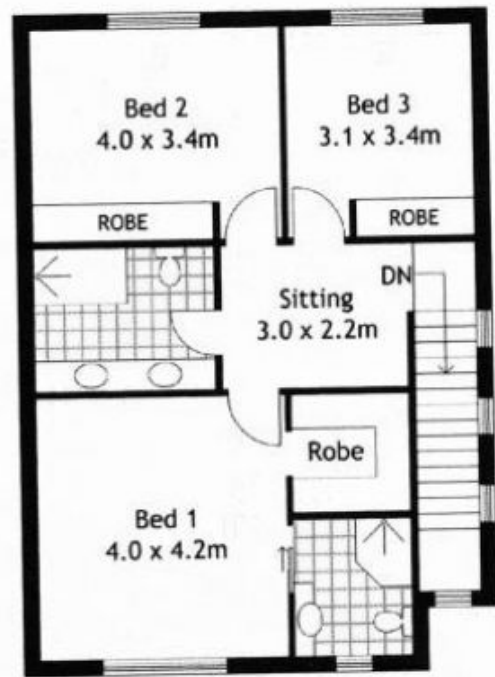

Upper Level Plan

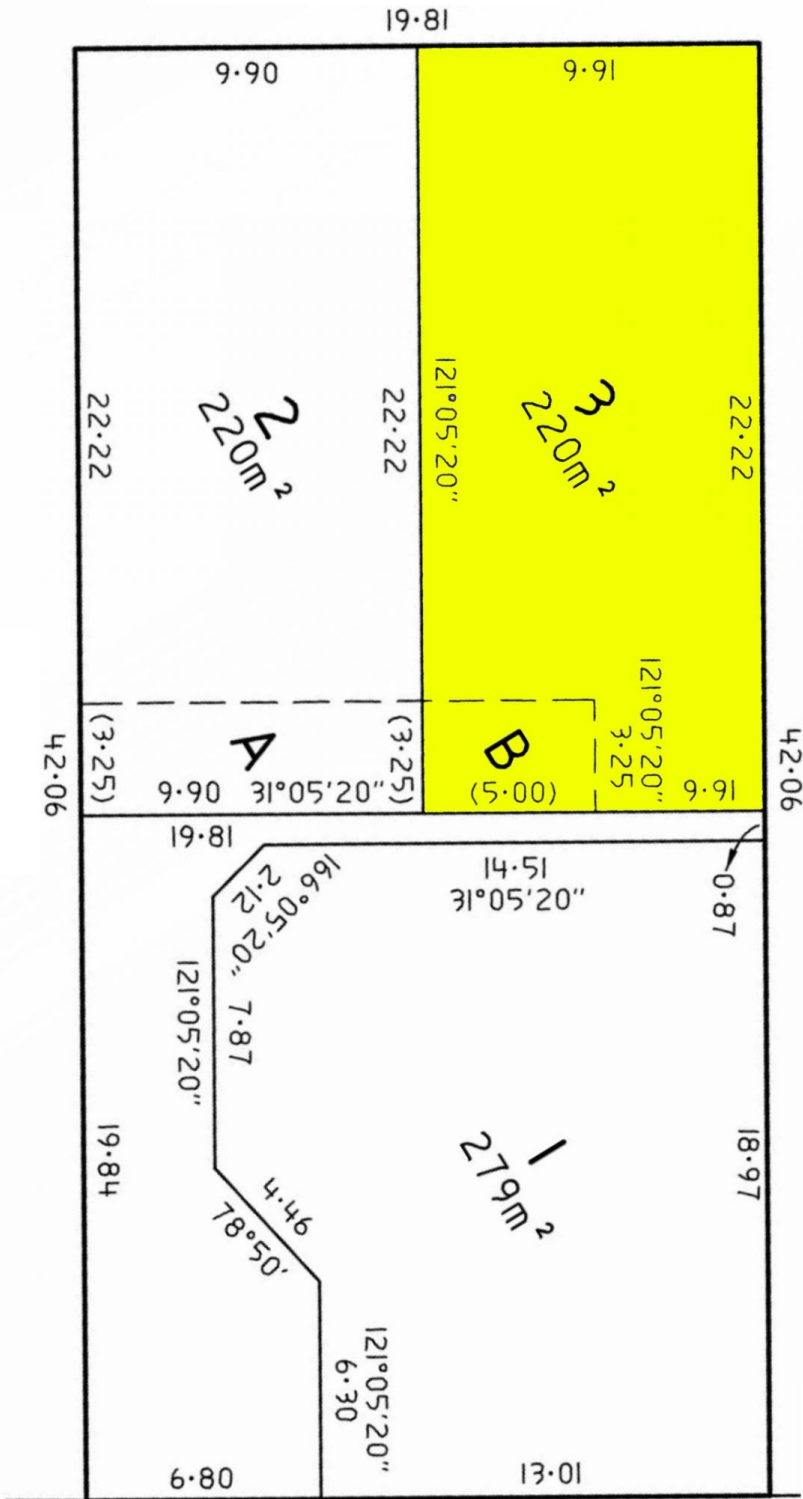

BIRDWOOD TERRACE

