



30 Griggs Drive ATHELSTONE SA

3 2 2

Quiet locations like Griggs Drive in Athelstone are what buyers want in life. All the homes have big blocks with lovely gardens and a stunning view to the hills. It truly is awesome!

This attractive home has plenty of space and is ready to go. You could add value to the property by doing some cosmetic upgrades if you wanted and have the enjoyment of putting your own stamp on your next family home.

- 3 living rooms.
- Main bedroom with ensuite bathroom.
- Second bathroom.
- 3 bedrooms in total.
- Central kitchen.
- Lovely under cover alfresco entertaining area.
- Lock up garage with handy drive through access.

Price : \$ 445,000
Land Size : 550 sqm
View : <https://www.bruse.com.au/sale/sa/north-north-east-suburbs/athelstone/residential/house/5551726>



Theon Bruse
08 8431 8181

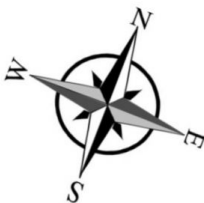
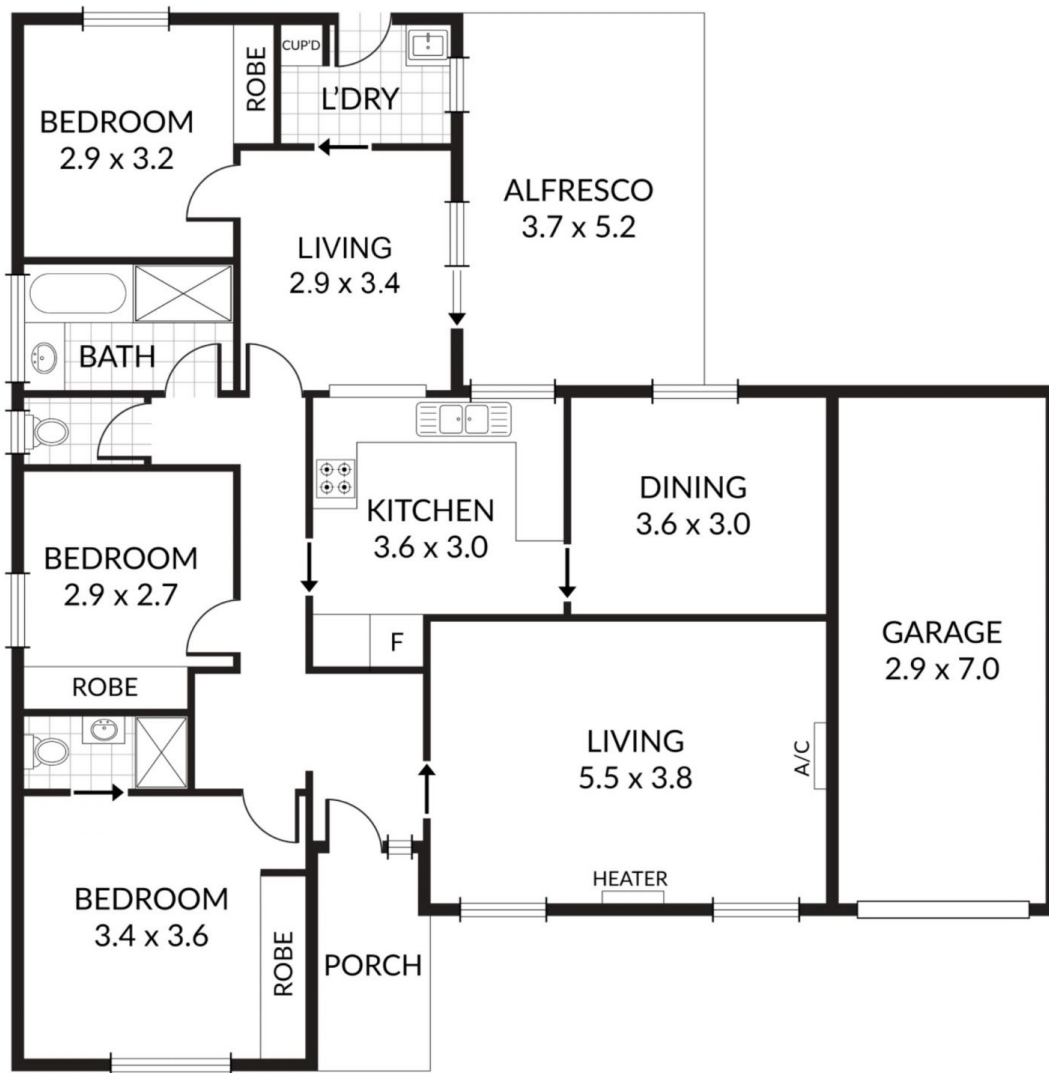

Scale in metres. Indicative only. Dimensions are approximate. All information contained herein is gathered from sources we believe to be reliable. However we cannot guarantee its accuracy and interested persons should rely on their own enquiries