



3 Aerial Road Belair SA

2 1 2

Build in Beautiful Belair.

Perfectly set amid a tranquil bush setting in a highly sought after pocket awaits this exciting opportunity to renovate and/or extend this sold brick house or build your dream home on this huge Torrens Title allotment (STCC).

- Land size - 1,420m² of land
- Dimensions - 19.45m frontage x 60.10m depth x 24.40m rear boundary
- Zoned - Residential Hills

A unique advantage of this beautiful piece of land is the access road along the whole western boundary. Accessing machinery for renovating and building has never been easier!

Price : \$ 685,000
Land Size : 1420 sqm
View : <https://www.bruse.com.au/sale/sa/south-sou-th-east-suburbs/belair/residential/house/6722561>



Toby Shipway
8413 8181

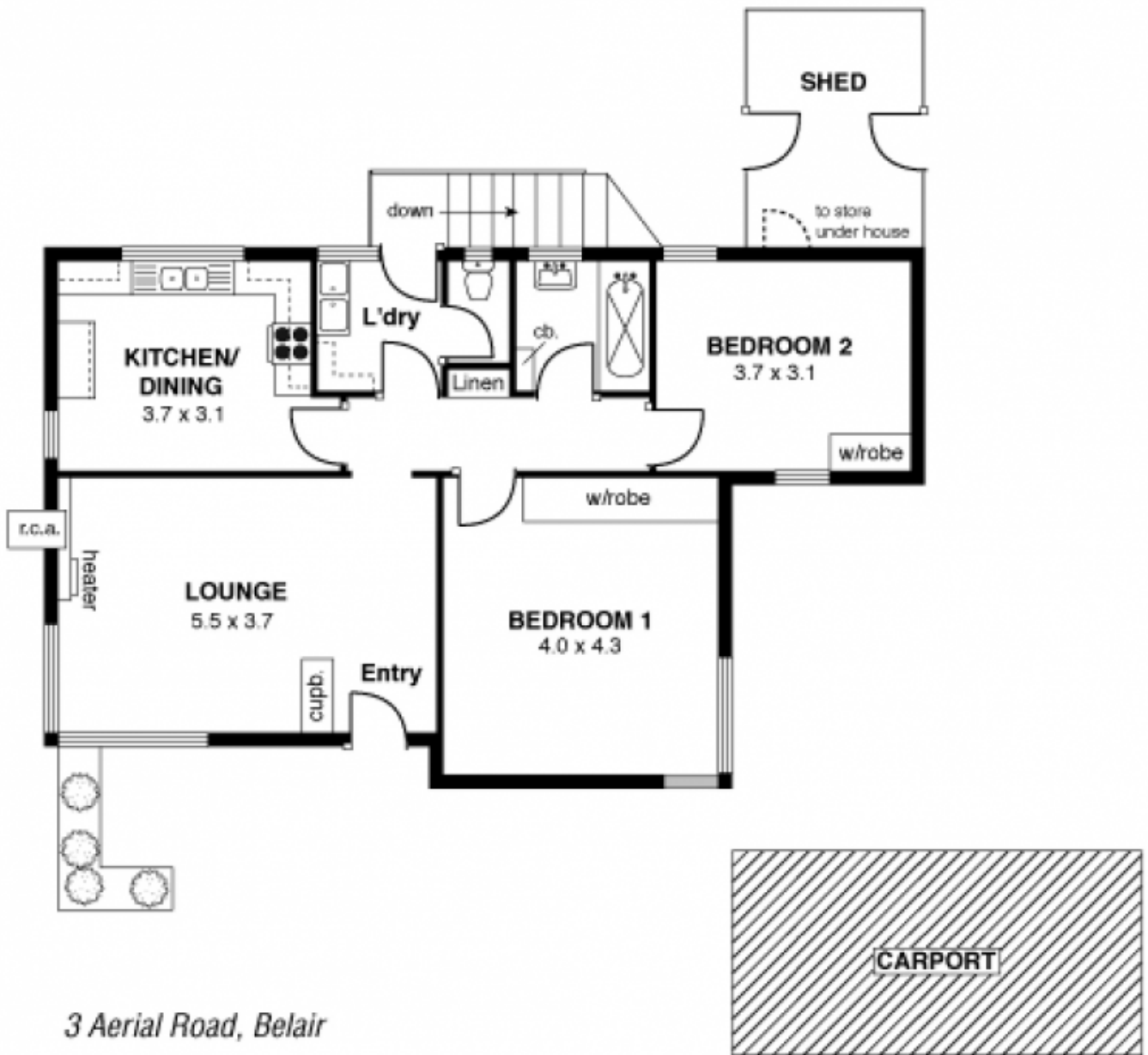

3 Aerial Road, Belair

| APPROXIMATE ESTIMATED AREA | |
|----------------------------|------------------------|
| Living | 86.3 |
| Carport | 18.0 |
| TOTAL | 104.3 sqm. app. |