



#### 4 Antares Way Athelstone SA

4 2 4

This solid brick home is in original condition but offers the opportunity for any buyer to move in and live and enjoy the home as is and then refurbish and decorate to suit their own needs over a period of years. It is a clean, neat, tidy home at this point. Certainly, well cared for by the current owners.

THE HOME IS IN A WONDERFUL LOCATION, surrounded by other quality homes and is a very desirable spot close to shopping, transport, schools and everything else that this prime location of Athelstone offers.

Do not miss out on it, it is a very rare find! 4 BEDROOMS, 2 BATHROOMS.

The home itself has an entrance hallway that leads to the generous living room; this room has further access through

**Price** : \$ 710,000  
**Land Size** : 590 sqm  
**View** : <https://www.bruse.com.au/sale/sa/north-north-east-suburbs/athelstone/residential/house/7276525>



**Bevan Bruse**  
08 8431 8181



**Theon Bruse**  
08 8431 8181

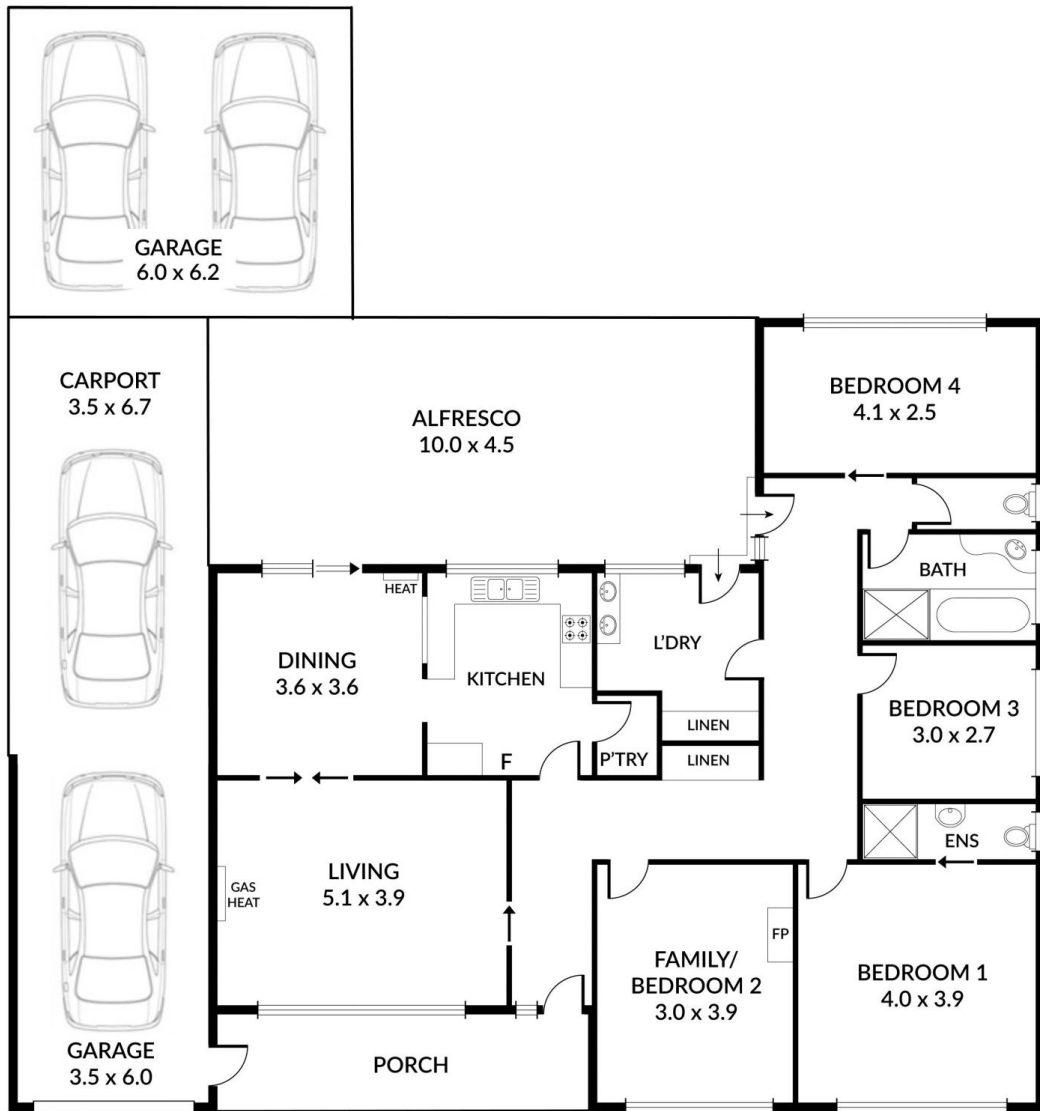

Scale in metres. Indicative only. Dimensions are approximate. All information contained herein is gathered from sources we believe to be reliable. However we cannot guarantee its accuracy and interested persons should rely on their own enquiries

Easements **A** & **B** are for sewerage and drainage purposes.

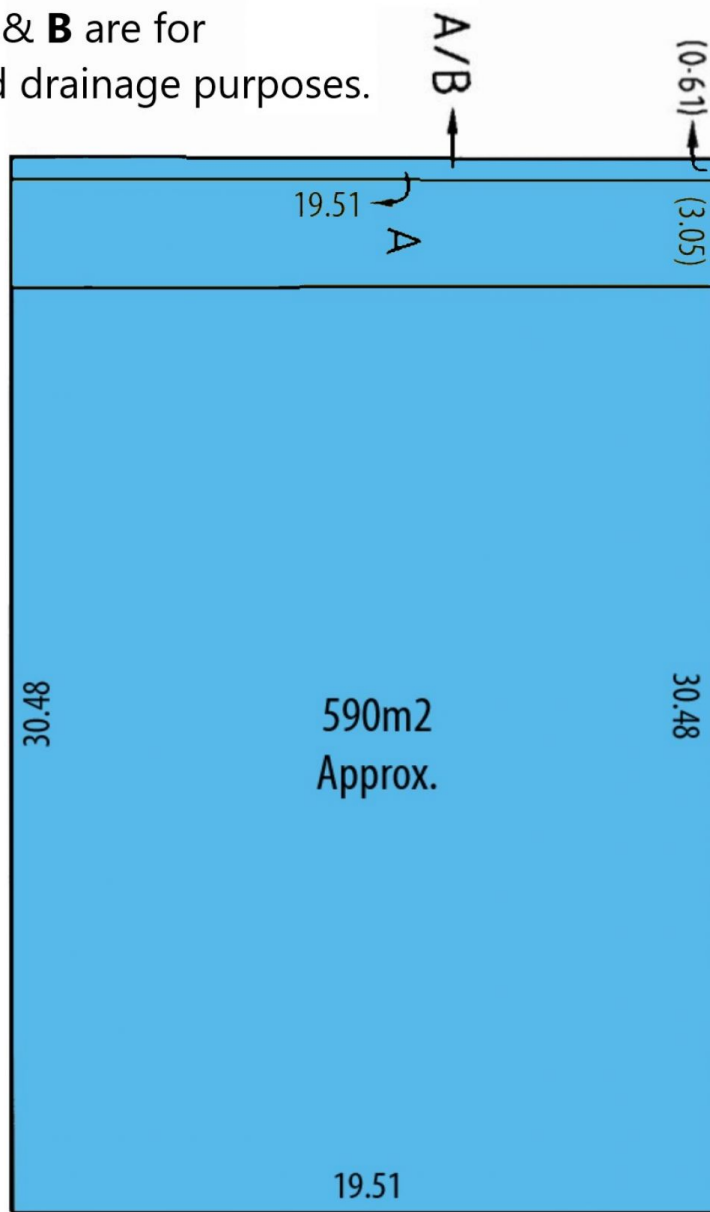

ANTARES WAY